

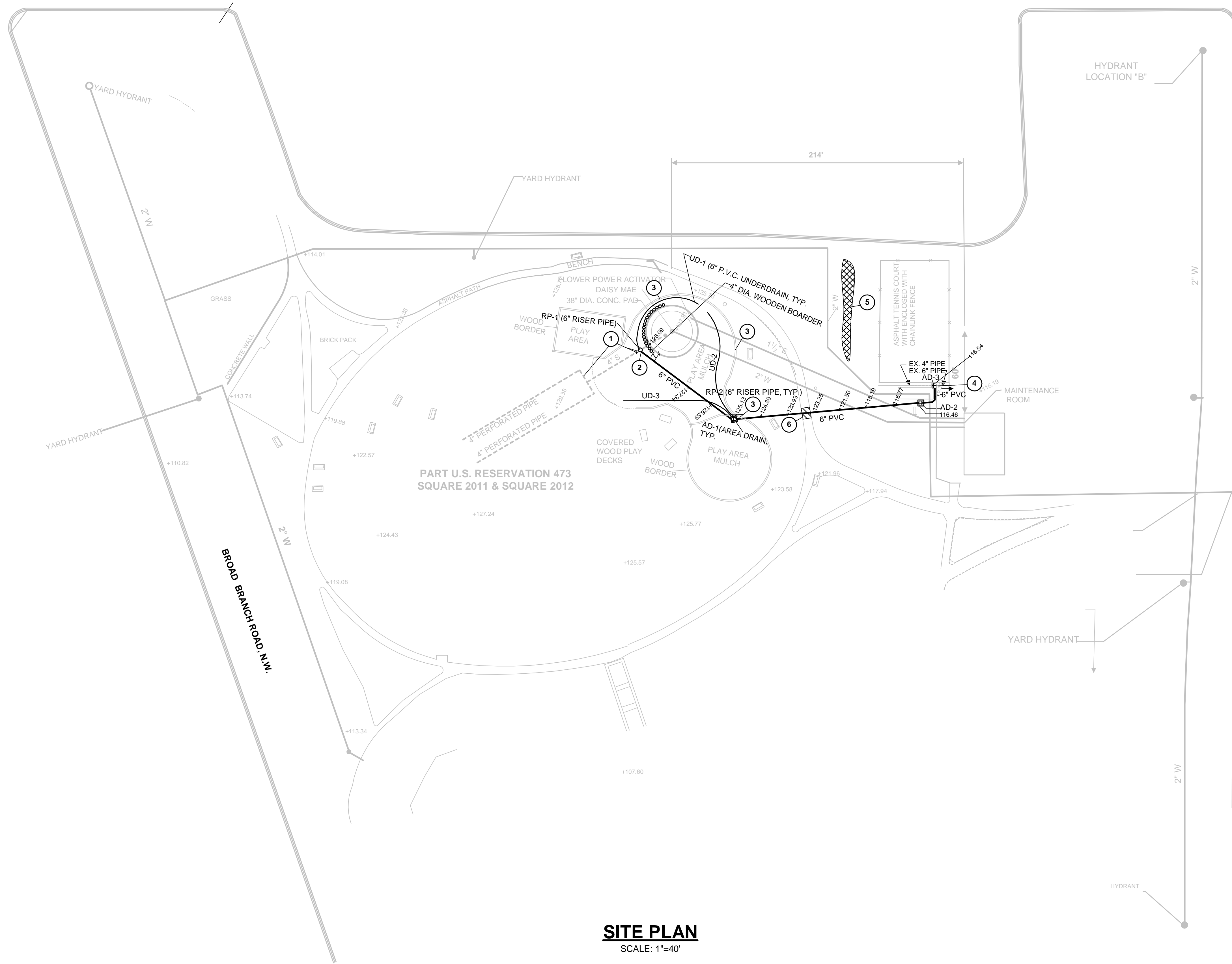

QUESADA STREET, N.W.



KEYED-IN NOTES:

- ① ABANDON EXISTING FRENCH DRAIN BY CUTTING AND CAPPING THE EXISTING 4 INCH P.V.C. PIPE.
- ② REDIRECT THE EXISTING 4 INCH P.V.C. FROM THE EXISTING CONCRETE PLATFORM TO THE NEW AREA DRAIN (AD-1) USING A 6 INCH DIAMETER RISER PIPE WHICH ALSO SERVES AS A CLEAN-OUT AND TO INTERCEPT FLOWS FROM UNDER-DRAINS.
- ③ REPLACE ROTTEN WOODEN BORDER AS NECESSARY
- ④ REMOVE EXISTING AREA DRAIN AND EXTEND THE INCOMING 4 INCH PIPE TO AD-3
- ⑤ SOD ERODED AREA WITH 4" TOP SOIL
- ⑥ REPAIR ASPHALT PATH

GENERAL NOTES:

1. ALL UNDERDRAINS SHALL BE PERFORMED P.V.C. PIPE WRAPPED WITH FILTER CLOTH. FLEXIBLE PERFORATED H.D.P.E. PIPE CAN BE USED.
2. ALL WOODEN BORDERS SHALL BE PRESSURE-TREATED, AND SHALL BE DRIVEN ABOUT THREE (3) FEET DEEP, AND 4 INCHES ABOVE GROUND. AT UTILITY CROSSINGS, BORDERS SHALL BE DRIVEN ABOUT ONE FOOT BUT MUST BE ANCHORED IN CONCRETE OR ANCHORED TO THE ADJACENT BORDERS. THE DRIVING-IN EDGE MUST BE SHARP.
3. THE CONTRACTOR SHALL NOTIFY THE FOLLOWING PARTIES AT LEAST 48 HOURS PRIOR TO ANY EXCAVATION WORK:
 GENERAL UTILITY INFORMATION: MISS UTILITY - 1-800-257-7777
 WATER AND SEWER SERVICES: DC WASA - (202) - 612 - 3400
 EROSION AND SEDIMENT CONTROL: DCRA - (202) - 645 - 6059
4. ALL GRADED AREAS OR DISTURBED AREAS, INCLUDING SLOPES, SHALL BE PROTECTED DURING CLEARING AND CONSTRUCTION IN ACCORDANCE WITH THE APPROVED EROSION AND SEDIMENT CONTROL PLAN UNTIL THEY ARE ADEQUATELY STABILIZED.
5. ALL EROSION AND SEDIMENT CONTROL PRACTICES AND MEASURES SHALL BE CONSTRUCTED, APPLIED, AND MAINTAINED IN ACCORDANCE WITH APPROVED SEDIMENT CONTROL STANDARDS AND SPECIFICATIONS.
6. THE EXISTING PLAN INFORMATION USED TO PREPARE THESE PLANS WERE BASED ON RECORD DRAWINGS FURNISHED BY DPR. THE CONTRACTOR SHALL VERIFY ALL EXISTING INFORMATION IN FIELD AND MAKE PROPER ADJUSTMENTS TO LOCATION OF STRUCTURES. ALL CHANGES MADE DURING CONSTRUCTION SHALL BE RED-LINED AND USED TO PREPARE AS-BUILT PLANS.
7. THE CONTRACTOR SHALL VERIFY, BY FIELD MEASUREMENT, THE REQUIRED DIMENSIONS OF ALL PIPES, FITTINGS, AND OTHER STRUCTURES PRIOR TO FABRICATION OR INSTALLATION.

SITE PLAN
SCALE: 1"=40'

DESIGNED BY: EM					
DRAWN BY: DH					
CHECKED BY: AAE					
CERTIFICATION	REV. NO.	DATE	DESCRIPTION	BY: EM	APPR. BY:
	City Engineers, Inc. 2421 Pennsylvania Ave., N.W., #300 Washington, D.C. 20037 240.462.5820P 301.203.7287F			SHEET TITLE :	
	CLIENT: K.C. Home Improvements & Construction, Inc. 1202 H Street, N.E. Washington, D.C. 20002 202.213.5094			SITE PLAN	
REGISTRATION NO.: PE 10691	OWNER: Department of Parks and Recreation 1480 Girard Street, N.W., #400 Washington, D.C. 20009			DRAWING NO.: C-1	
DATE:.....	PROJECT: Drainage Improvements at Lafayette Recreational Center			PROJ. NO.:	
				SCALE: 1" = 40'	
				DATE: OCTOBER, 2008	
				SHEET 1 OF 2	